

REVISIONS			
REV	DESCRIPTION	DATE	BY
A	ECO #2136196 - INITIAL RELEASE	09/20/13	RDR

D

C

B

A

TRIM LEAD LENGTH TO 7.00MM
PRIOR TO ASSEMBLY

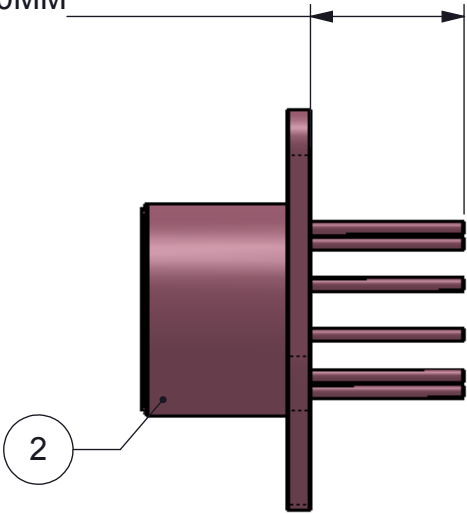

InGaAs DETECTOR
MODIFICATION

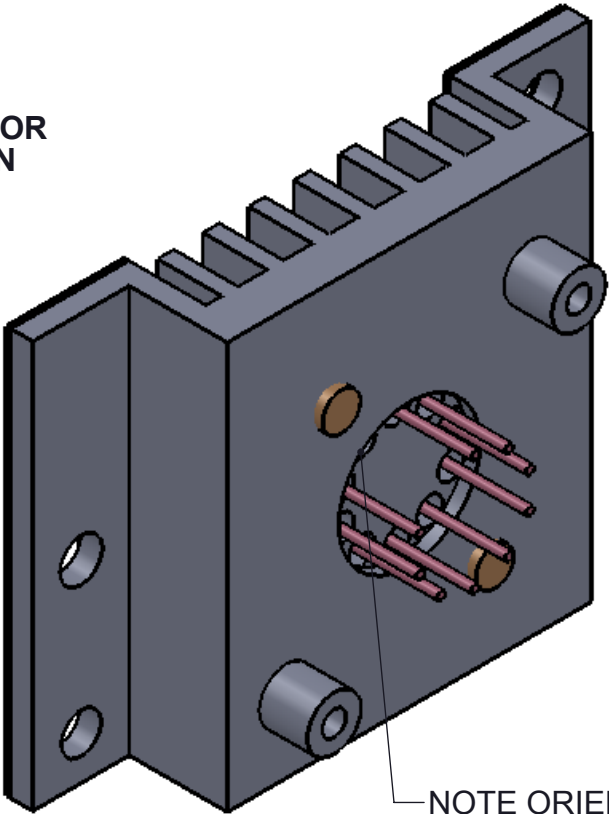

NOTE ORIENTATION OF
InGaAs DETECTOR DURING
ASSEMBLY

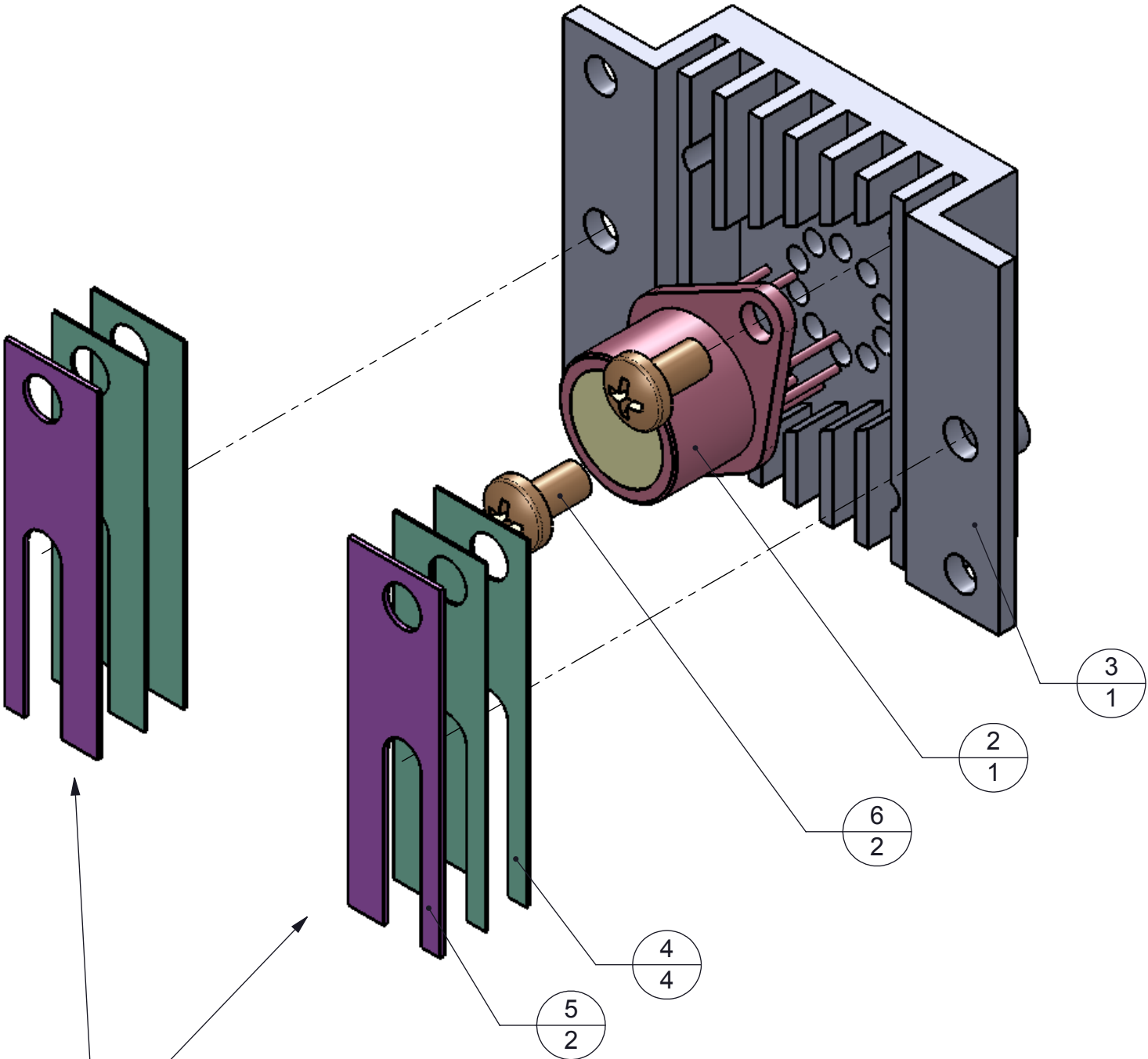

SHIMS PROVIDED TO BE USED AS
REQUIRED DURING CALIBRATION PROCEDURE

2	6	SCREW 6-32 x .25 LG PHP	SCREW 6-32 x .25 LG PHP	
2	5	2513415	SHIM, DETECTOR ADJUST, .50MM	
4	4	2513414	SHIM, DETECTOR ADJUST, .25MM	
1	3	2513416	HEATSINK, DETECTOR	
1	2	InGaAs DETECTOR	InGaAs DETECTOR	
REF	1	SKELETON LAYOUT - DETECTOR ASSY	SKELETON LAYOUT - DETECTOR ASSY	REFERENCES TO 3D CAD DATABASE
QTY	ITEM	PART NUMBER	DESCRIPTION	Notes

UNLESS OTHERWISE SPECIFIED • DIMENSIONS ARE IN MILLIMETERS • TOLERANCES: ANGLES ±1° 2 PLACE DECIMALS ±0.25 1 PLACE DECIMALS ±0.50 • DIMENSIONAL LIMITS APPLY BEFORE PROCESSES • INTERPRET DIMENSIONS IN ACCORDANCE WITH ASME Y14.5M-1994 • REMOVE ALL BURRS AND SHARP EDGES • PARENTHETICAL INFO FOR REF ONLY		DWN R ROWE	DATE 9/13/2013	TEXAS INSTRUMENTS	
		Engr			
		CQE/QA		DETECTOR MODULE ASSEMBLY	
		CM			
NEXT ASSY		USED ON	Apprvd	SCALE 2:1	REV A
APPLICATION				SHEET 1 OF 1	